

OZ LOADSAFE LEVER HOIST

Capacity: 800kg to 9 tonnes

Features:

- Unique hand wheel and free wheel knob design.
- Improved hook tips with cast self-locking latches.
- Innovative, patented friction disc with no brake discs required.
- Caged roller bearings on the load sprocket.
- Dacromet finish on the ratchet disc, cam, disc hub and change over disc.
- Intergrated safety overload clutch.
- Weston brake with twin pawls.
- Stainless steel name plates.
- Minimum handle effort required to raise loads.
- Loadchain includes enlarged end ring.
- Super strength plated alloy loadchain.
- All steel construction.
- Powder coated paint finish.



Applications:

This new robust lever hoist has many application choices for use in construction, engineering, forestry, automotive, offshore and underground mining when a safe reliable hoist with increased working load is needed.

Complies to AS1418.2

Meets or exceeds the following standards:

- ANSI B30.21
- ANSI B30.16



Product Model Code		LSLH08	LSLH16	LSLH32	LSLH63	LSLH90
Capacity W.L.L.	tonnes	0.8	1.6	3.2	6.3	9.0
Loadchain falls		1	1	1	2	3
Loadchain Dia. x pitch	mm	5.6x15.7	7.1x19.9	10x28	10x28	10x28
Pull to lift rated load	N	215	303	372	382	392
Proof Load	kg	1200	2400	4800	9500	13500
Stand lift	m	1.5	1.5	1.5	1.5	1.5
Net weight	kg	5.7	8.0	13.6	26.0	40.0
Gross weight	kg	6.1	8.5	14.2	26.6	46.5
Extra weight/metre of chain	kg	0.7	1.1	2.3	4.7	7.0
Dimensions mm	a	146	164	196	196	196
	b	119	126	159	218	298
	c	41.5	52	61.9	84.3	-
	d	280	335	395	540	680
	e	245	265	415	415	415
	f	96	100	114	114	114
	g	26.5	35.5	43	53	64
	h	35.5	42.5	50	60	85
	i	14	19	24.5	34	40

COMPLIES WITH AS/NZS1418.2

Meets or exceeds all relevant world standards

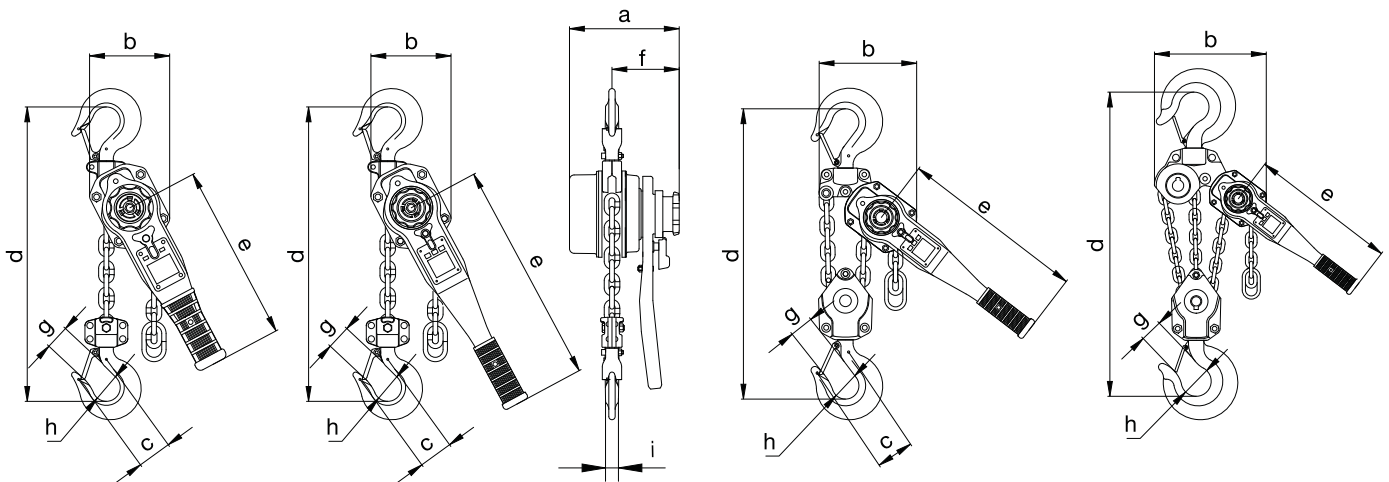

0.8, 1.6 tonne

3.2 tonne

6.3 tonne

9 tonne